

# SSLA

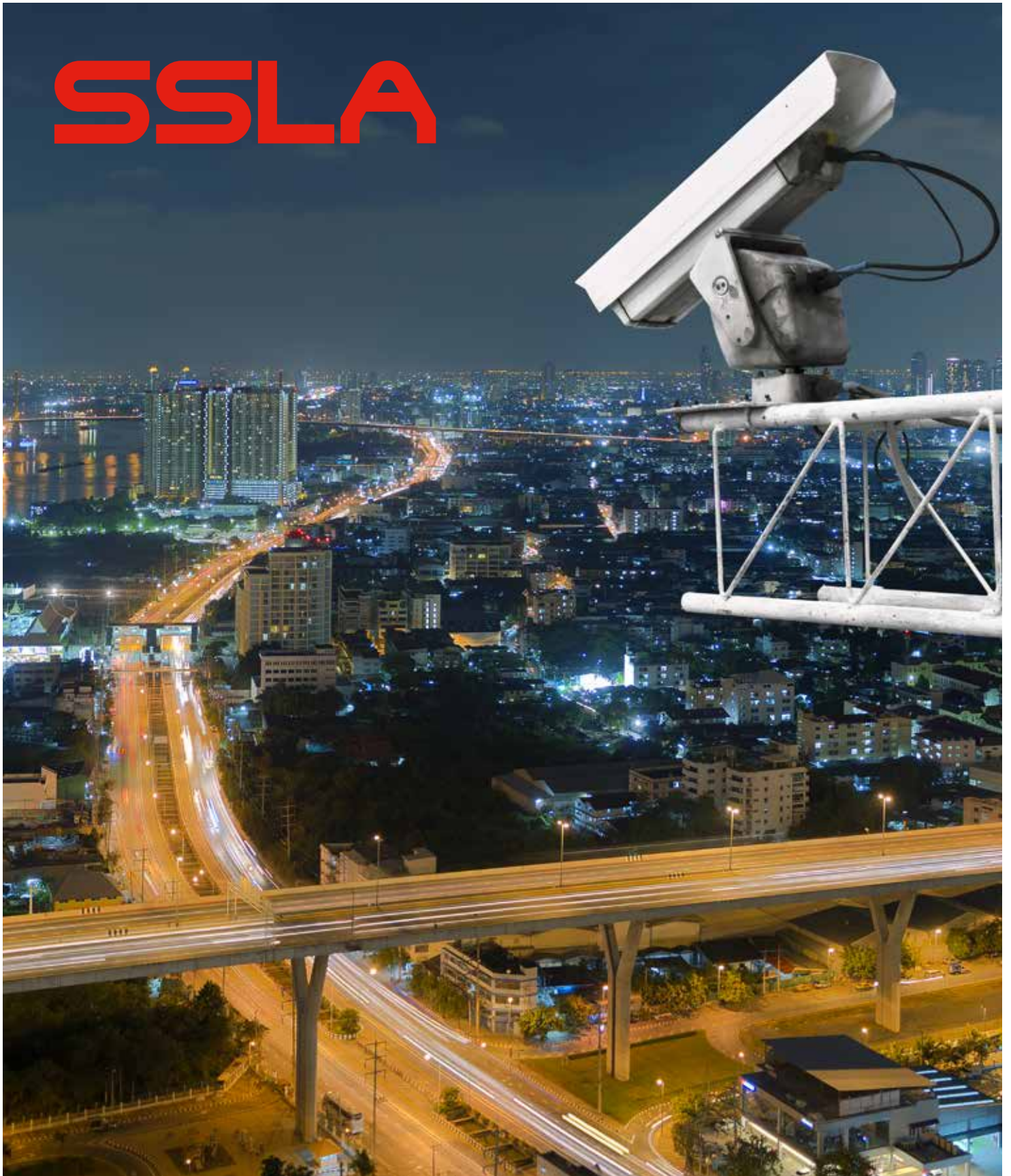

SSLA Battery Range

**FIAMM**  
+ -

+  
FIAMM.COM

**T**HE SSLA BATTERY RANGE HAS BEEN DESIGNED TO COVER A WIDE RANGE OF APPLICATIONS. THE FOOTPRINT OF BATTERIES IS ALSO IDEAL FOR CRITICAL INSTALLATIONS. CONNECTION IS SIMPLE ON SMALLER MODELS SIZES THANKS TO THE EASY 'FAST-ON' TERMINALS.

THE FIAMM SSLA RANGE HAS FOUR DIFFERENT PRODUCT FAMILIES. EACH ONE IS SPECIFICALLY DESIGNED TO OPTIMISE THE BEST SOLUTION FOR THE APPLICATION.

**FG** DESIGNED TO MEET MEDIUM TO LONG DISCHARGE RATES AND WITH A DESIGN LIFE OF 5 YEARS. THE RANGE IS AVAILABLE IN 6V OR 12V BLOCKS WITH A CAPACITY RANGE OF 1.2 - 70AH.

**FGH** DESIGNED FOR MAXIMUM PERFORMANCE IN CRITICAL POWER APPLICATIONS SUCH AS UPS. THE RANGE IS AVAILABLE IN 12V BLOCKS WITH A CAPACITY RANGE OF 5 - 18AH.

**FGHL** CLASSIFIED "LONG LIFE" ACCORDING EUROBAT INDUSTRY STANDARD, WHICH MEANS 10 YEARS DESIGN LIFE. THE RANGE IS AVAILABLE WITH A CAPACITY RANGE OF 5 - 12AH.

**FGC** AN IDEAL SOLUTION FOR CYCLIC APPLICATIONS WITH A DESIGN LIFE OF 5 YEARS. RANGE IS AVAILABLE FROM 12 - 42AH.

THESE PRODUCTS ARE DESIGNED TO GIVE A WIDE RANGE OF SOLUTIONS TO ALL APPLICATIONS AND OFFER UNSURPASSED PROVEN RELIABILITY, COMPLIANT WITH THE HIGHEST RECOGNISED INTERNATIONAL STANDARDS. SSLA USES VRLA TECHNOLOGY WITH 99% INTERNAL RECOMBINATION EFFICIENCY, IS NON-SPILLABLE AND MAINTENANCE FREE THEREFORE REQUIRES NO TOPPING UP OF ELECTROLYTE DURING ITS FLOAT-LIFE. SSLA RANGE IS NON-HAZARDOUS FOR AIR/SEA/RAIL/ROAD TRANSPORTATION AND IS 100% RECYCLABLE. SSLA HAS A SELF-DISCHARGE RATE LESS THAN 2% PER MONTH, GUARANTEEING LONG SHELF-LIFE.

\*SSLA (SMALL SEALED LEAD ACID) ARE BATTERIES WITH CAPACITY (AH) TILL MAX 24AH. THE FIAMM SSLA FIAMM RANGE CONTAINS SOME SIZES THAT EXCEED THIS LIMIT. HOWEVER SOME SIZES ARE OF A LARGER CAPACITY DUE TO APPLICATIONS.

#### MAIN APPLICATIONS:



UPS



SECURITY SYSTEMS AND EMERGENCY LIGHTING



LIGHT TRACTION



LEISURE



## SPECIFICATIONS

Special lead calcium tin alloy grid, designed to resist corrosion and provide short recharge time

VRLA AGM technology using low resistance high microporous fiberglass separators

Leak resistant post seal, faston, flag and threaded female, terminals with high conductivity and maximum torque resistance

One-way safety relief valves allow gas to escape and prevent the ingress of oxygen

ABS plastic (for FGHL range flame retardant ABS plastic to IEC 707 FV0 and UL94 FV0 - LOI greater than 28%)

Installation in any orientation (excluding permanently inverted)

## TERMINALS TYPE

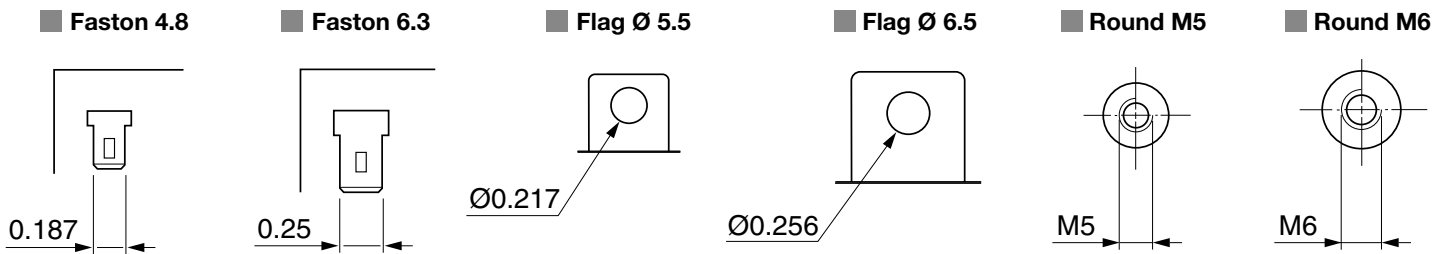

## TECHNOLOGY

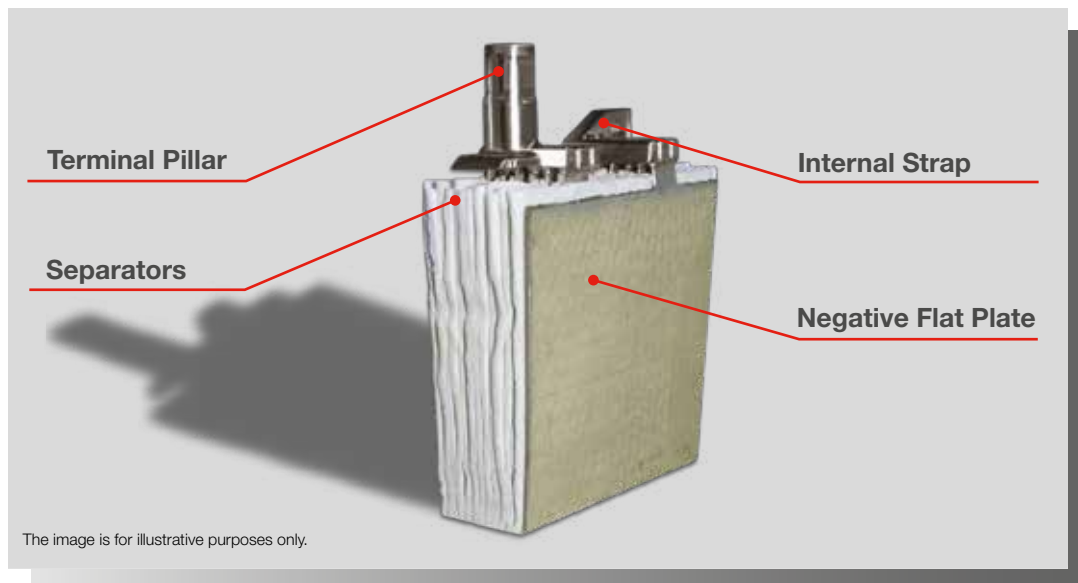

FIAMM SSLA RANGE USE AGM (ABSORBED GLASS MAT) TECHNOLOGY. THE ELECTROLYTE IS ABSORBED IN FIBERGLASS SEPARATORS WITH 99% INTERNAL GAS RECOMBINATION EFFICIENCY. BLOCS ARE GRANTS NON-SPILLABLE AND MAINTENANCE FREE THEREFORE REQUIRES NO TOPPING UP OF ELECTROLYTE DURING ITS WHOLE LIFE. LOW SELF-DISCHARGE ALLOWS 6 MONTHS SHELF LIFE.



BATTERY TYPE	VDS*	NOMINAL VOLTAGE (V)	CAPACITY (Ah) 20 H to 1.75 VPC at 77°F	NOMINAL DIMENSIONS (in.)				TYPICAL WEIGHT (lbs)	TERMINAL TYPE
				Length	Width	Height	Tot. Height**		
FG 10121		6	1.2	3.82	0.94	2.01	2.28	0.62	Faston 4.8
FG 10301	•	6	3.0	5.28	1.30	2.36	2.60	1.32	Faston 4.8
FG 10381		6	3.8	2.60	1.30	4.69	4.92	1.34	Faston 4.8
FG 10451		6	4.5	2.76	1.85	3.98	4.17	1.59	Faston 4.8
FG 10721		6	7.2	5.91	1.34	3.70	3.94	2.65	Faston 4.8
FG 11201	•	6	12	5.94	1.97	3.66	3.90	3.97	Faston 4.8
FG 11202	•	6	12	5.94	1.97	3.66	3.90	3.97	Faston 6.3
FG 20121	•	12	1.2	3.82	1.89	2.01	2.24	1.19	Faston 4.8
FG 20121A		12	1.2	3.82	1.69	2.01	2.28	1.15	Faston 4.8
FG 20201	•	12	2.0	7.01	1.38	2.36	2.56	1.76	Faston 4.8
FG 20271		12	2.7	3.11	2.20	3.90	4.13	2.43	Faston 4.8
FG 20341		12	3.4	5.28	2.56	2.36	2.60	2.87	Faston 4.8
FG 20451		12	4.5	3.54	2.76	3.98	4.21	3.31	Faston 4.8
FG 20721	•	12	7.2	5.94	2.56	3.74	3.98	5.07	Faston 4.8
FG 20722	•	12	7.2	5.94	2.56	3.74	3.98	5.07	Faston 6.3
FG 21201	•	12	12	5.94	3.86	3.74	3.94	8.38	Faston 4.8
FG 21202	•	12	12	5.94	3.86	3.74	3.94	8.38	Faston 6.3
FG 21803	•	12	18	7.13	2.99	6.57	6.57	12.1	Flag Ø5.5
FG 22703	•	12	27	6.54	6.89	4.92	4.92	19.2	Flag Ø5.5
FG 24204	•	12	42	7.76	6.50	6.69	6.69	29.8	Flag Ø6.5
FG 27004	•	12	70	13.78	6.54	6.85	6.85	51.4	Flag Ø6.5

\* Model available also with VDS

\*\*Tot. Height = total height including terminals



BATTERY TYPE	NOMINAL VOLTAGE (V)	CAPACITY (Ah) 20 H to 1.75 VPC at 25°C	NOMINAL DIMENSIONS (mm)				TYPICAL WEIGHT (kg)	TERMINAL TYPE
			Length	Width	Height	Height (terminal)		
FGC 21202	12	12	151	98	95	100	4.0	Faston 6.3
FGC 21803	12	18	181	76	167	163	6.3	Flag Ø5.5
FGC 22705	12	27	166	175	125	113	9.3	Round M5
FGC 23505	12	35	197	130	159	157	11.1	Round M5
FGC 24207	12	42	199	166	171	153	13.4	Round M6



# FGH

BATTERY TYPE	NOMINAL VOLTAGE (V)	CAPACITY (Ah) 20 H to 1.75 VPC at 25°C	NOMINAL DIMENSIONS (mm)				TYPICAL WEIGHT (kg)	TERMINAL TYPE
			Length	Width	Height	Height (terminal)		
12 FGH 23 slim	12	5.0	151	51	95	100	1.9	Faston 4.8
12 FGH 23	12	5.0	90	70	101	107	1.8	Faston 6.3
12 FGH 36	12	9.0	151	65	95	100	2.7	Faston 6.3
12 FGH 50	12	12	151	98	95	100	3.8	Faston 6.3
12 FGH 65	12	18	181	76	167	163	5.6	Flag Ø5.5

# FGHL

BATTERY TYPE	NOMINAL VOLTAGE (V)	CAPACITY (Ah) 20 H to 1.75 VPC at 25°C	NOMINAL DIMENSIONS (mm)				TYPICAL WEIGHT (kg)	TERMINAL TYPE
			Length	Width	Height	Height (terminal)		
12 FGHL 22	12	5.0	90	70	101	106	1.9	Faston 6.3
12 FGHL 28	12	7.2	151	65	95	100	2.6	Faston 6.3
12 FGHL 34	12	8.4	151	65	95	100	2.7	Faston 6.3
12 FGHL 48	12	12	151	98	95	100	4.0	Faston 6.3

## ELECTRICAL CHARACTERISTICS

Float Voltage: 2.25-2.30 V/cell at 77°F  
 Boost Voltage for cyclic use: 2.40-2.50 V/cell at 77°F  
 Float Voltage Compensation with Temperature: -1.39 mV/cell/°F  
 Self-Discharge at 77°F: <2%/month

## STANDARDS

IEC 60896 Part 21 - VRLA methods of testing  
 IEC 60896 Part 22 - VRLA requirements  
 Eurobat "3-5 years standard commercial" for FG FGH  
 FGC and "10-12 years long life" for FGHL  
 UL Recognized

# CERTIFICATIONS

ISO 9001  
Quality Management System

ISO 14001  
Environmental Management System

OHSAS 18001  
Workplace Safety & Health

## DISCHARGE CURVES at different current / final voltage (at 77°F)

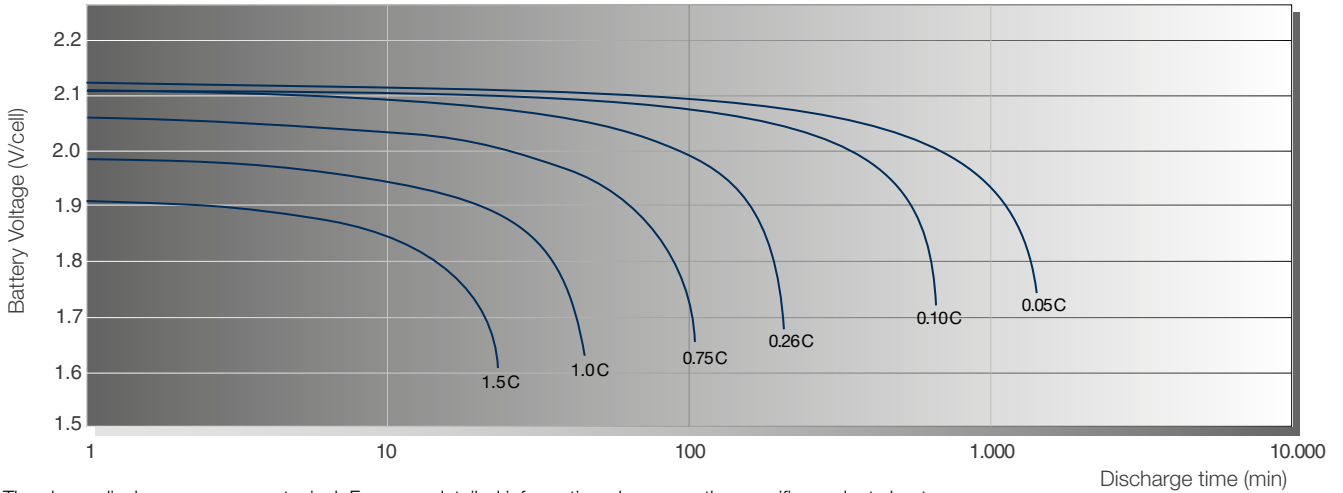

The above discharge curves are typical. For more detailed information please see the specific product sheets.

## TYPICAL CHARGE CURVES

Battery Voltage and Charge Time for Standby Use (at 77°F)

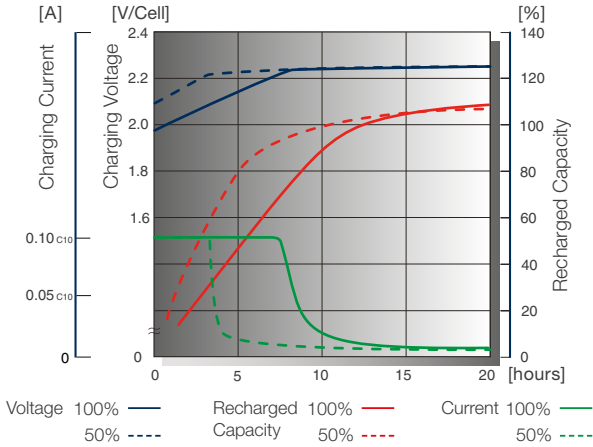

## STORAGE

Capacity loss during storage at various temperatures

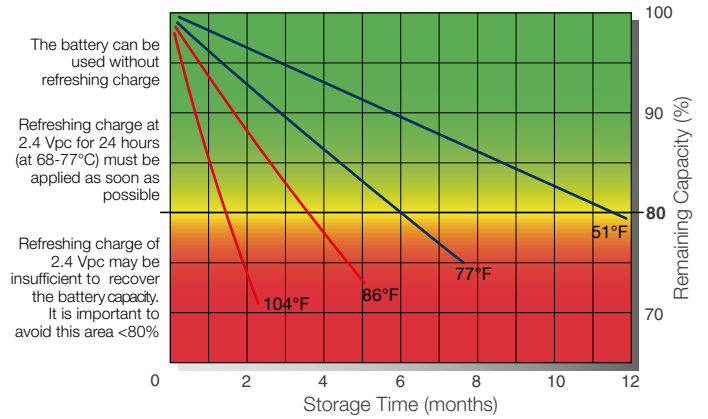

### FIAMM Energy Technology (USA) LLC

One FIAMM Way  
30830 - Waynesboro GA (U.S.A.)  
Tel. +1 (706) 437-3220  
Fax +1 (706) 437-3300

A Hitachi Group Company

info.industrial.northamerica@fiamm.com  
www.fiamm.com

fiamm.batteries

fiambatteries

youtube.com/user/FIAMMvideo