



## TS5.224V Size 2-4 Architectural Slimline Overhead Door Closer

RS Stock No 1754967

### Product Overview:

An efficient, durable and stylish variable power overhead door closer. Suitable for most applications particularly those with constant use which require a backcheck function.

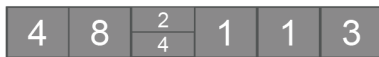

### Testing & Standards:

- CE marked against EN1154
- Included in successful fire test to EN1634
- Suitable for use on timber fire doors of up to 120 minutes fire resistance
- Safe in use
- High corrosion resistance

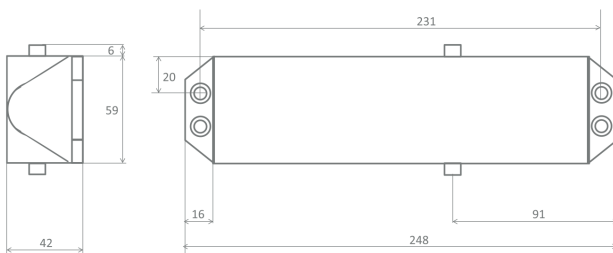

### Specification

Closing Force (Fig 1)	EN Size	2-4
Door Size (max)	Width (mm)	1100
	Weight (kg)	80
Body Dimensions	Length (mm)	248
	Width (mm)	59
	Depth (mm)	42
Application	Regular Fig. 1	y
	Parallel Arm Fig. 6	y*
	Transom Fig. 61	y*
Mechanism	Rack & Pinion	y
Power Shoe Bracket		y
Angle Of Opening		180°
Non Handed		y
Power Adjustment By Spring		y
Power Adjustment By Position		n
Adjustable Sweep Speed		y
Adjustable Latch Speed		y
Adjustable Backcheck		y
Adjustable Delayed Action		n
Guarantee	Years	25

### Options

Architrave Brackets	n
Drop Plates	n
Hold-Open Arm (not suitable for use on fire doors)	y*
Slide Arm & Track	n
Hollow Door Fixing Pack	n
Saddle Bracket For Glass Door Installation	n
Upstand Bracket For Over Panel Or UPVC Door	n

### Cover Options

Radius Edge	n
Semi-Radius	y
Full-Radius	n
Square	n

### Finish Options

Cover & Matching Armset	SIL, SSS, PSS, PB, RAL, BRONZE
-------------------------	--------------------------------------

\* these options are not covered by CE