

# CMM-SST | Hinges

Stainless steel



- 1
- 2
- 3
- 4
- 5
- 6
- 7
- 8
- 9
- 10
- 11
- 12
- 13
- 14
- 15
- RH

## MATERIAL

AISI 316 stainless steel.

## COLOUR

Natural, electropolished finish.

## ROTATING PIN

AISI 316 stainless steel.

## STANDARD EXECUTION

Pass-through holes for countersunk head screws.

## ROTATION ANGLE (APPROXIMATE VALUE)

Max 270° (-90° and +180° being 0° the condition where the two interconnected surfaces are on the same plane).

Do not exceed the rotation angle limit so as not to prejudice the hinge mechanical performance.

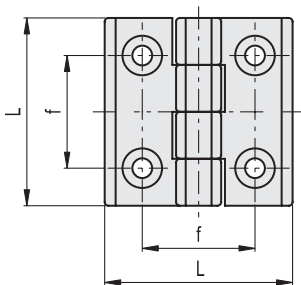
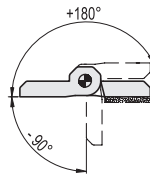
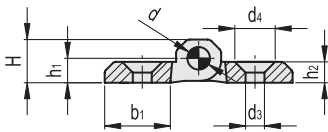

Code	Description	L	d3	d4	f	H	h1	h2	b1	d	△
428501	CMM-SST-40-SH-5	40	5.5	10.5	25	9	5.5	5	14	4	41
428601	CMM-SST-50-SH-6	50	6.5	12.5	30	11.5	6.5	6	18	6	81
428701	CMM-SST-60-SH-8	60	8.5	16.5	36	15	8.5	8	21.5	8	172