



## Product Datasheet

ENGLISH

# Flexible Polyolefin Heatshrink Tubing 2:1



### Applications:

General purpose tubing, it's low shrink temperature with flame retardant and widely used in high volume commercial applications such as jacketing wire bundles, light-duty harness, identifying or color-codes wires, cables, terminals, and components and so on.

### Characteristics:

Very flexible, highly flame-retardant (colors only)  
Resistant to common fluids and solvents  
Excellent physical and electrical performance

### Operating temperature range:

Operating temperature : -55 to +125 °C  
Minimum shrink temperature : 70 °C  
Minimum fully recovery temperature : 100 °C



**Technical Specification :**

**ENGLISH**

Property	Specification Requirements	Test Method	Typical Value
Concentricity	70%min.	ASTM D 2671	≥ 70%
Tensile strength	10.4MPa min.	ASTM D 638	≥ 12.0MPa
Elongation at break	200% min.	ASTM D 638	≥ 300%
Heat shock	No cracking	ASTM D 2671	Pass
Cold bend (-55°C,4 hrs.)	No cracking	ASTM D 2671	Pass
<b>Heat aging 158°C,168 hrs.</b>			
Tensile strength after aging	70% of original (MIN.)	ASTM D 638	≥ 80%
Elongation at break after aging	100% min.	ASTM D 638	≥ 200%
Dielectric voltage withstand and breakdown	2500V,60sec, No breakdown	UL224	Pass
Dielectric strength	19.7KV/mm min.	ASTM D 2671	25KV/mm
Volume resistance	10 <sup>14</sup> Ω · cm min.	ASTM D 876	≥ 10 <sup>14</sup> Ω · cm
Copper corrosion	No corrosion	ASTM D 2671	Pass
Copper stability	Elongation ≥ 100%	ASTM D 2671	Pass
Flammability	VW-1	UL224	Pass



Dimensions:

ENGLISH

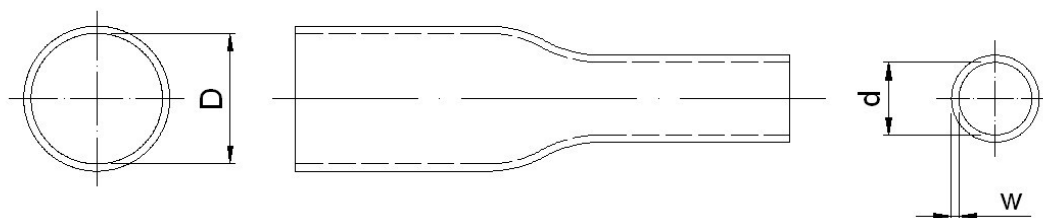

Part Number	Color	Dimensions		
		As Supplied (mm)	After Recovery (mm)	Wall Thickness Shrunk (mm)
		D (I.D.min.)	d (I.D.max.)	w(min)
700-4620	Black	1.6	0.8	0.36
700-4624	Black	2.4	1.2	0.44
700-4630	Black	3.2	1.6	0.44
700-4649	Black	4.8	2.4	0.44
700-4646	Black	6.4	3.2	0.56
700-4658	Black	9.5	4.8	0.56
700-4661	Black	12.7	6.4	0.56
700-4664	Black	19.0	9.5	0.77
700-4668	Black	25.4	12.7	0.87
700-4677	Red	1.6	0.8	0.36
700-4670	Red	2.4	1.2	0.44
700-4674	Red	3.2	1.6	0.44
700-4683	Red	4.8	2.4	0.44
700-4686	Red	6.4	3.2	0.56
700-4680	Red	9.5	4.8	0.56
700-4699	Red	12.7	6.4	0.56
700-4692	Red	19.0	9.5	0.77
700-4696	Red	25.4	12.7	0.87
700-4706	Yellow	1.6	0.8	0.36
700-4709	Yellow	2.4	1.2	0.44
700-4703	Yellow	3.2	1.6	0.44
700-4712	Yellow	4.8	2.4	0.44
700-4715	Yellow	6.4	3.2	0.56
700-4719	Yellow	9.5	4.8	0.56
700-4728	Yellow	12.7	6.4	0.56
700-4721	Yellow	19.0	9.5	0.77
700-4725	Yellow	25.4	12.7	0.87
700-4734	Blue	1.6	0.8	0.36
700-4737	Blue	2.4	1.2	0.44
700-4731	Blue	3.2	1.6	0.44
700-4740	Blue	4.8	2.4	0.44



ENGLISH

700-4743	Blue	6.4	3.2	0.56
700-4747	Blue	9.5	4.8	0.56
700-4756	Blue	12.7	6.4	0.56
700-4759	Blue	19.0	9.5	0.77
700-4753	Blue	25.4	12.7	0.87
700-4762	White	1.6	0.8	0.36
700-4765	White	2.4	1.2	0.44
700-4769	White	3.2	1.6	0.44
700-4778	White	4.8	2.4	0.44
700-4771	White	6.4	3.2	0.56
700-4775	White	9.5	4.8	0.56
700-4784	White	12.7	6.4	0.56
700-4787	White	19.0	9.5	0.77
700-4781	White	25.4	12.7	0.87