

TECHNICAL CHARACTERISTICS

SPECIFICATION

- >Rating: 50mA, 12VDC
- >Contact Resistance:
 - Initial: 100mOHM max.
 - After Life Test: 1OHM max.
- >Insulation Resistance: min. 100MOHM at 500VDC
- >Dielectric Strength: 250VAC for 1 minute

MATERIAL

- >Cover: Stainless Steel
- >Stem: PA46, UL HB
- >Frame: PA46, UL HB, color Black
- >Contact: Stainless Steel with silver cladding
- >Terminal: Copper alloy with silver plating
- >Tape: Polyimide tape

SOLDERING INFORMATION

- >Terminal in SMD version
- >Reflow soldering according to JEDEC J-STD-020D
- >Hand soldering under 350°C for 3 sec. max

ENVIRONMENTAL

- >Storage condition: -40°C ~ +85°C
- >Operation condition: -40°C ~ +85°C
- >Compliance: Lead Free, ROHS, Reach

PACKAGING INFORMATION

- >Tape & Reel

PN	Force	Color of Stem	Life cycle	Stroke
436 351 045 816	160g ± 50gf	White	200.000	0,25 mm ± 0,1
436 331 045 822	220g ± 50gf	Black	100.000	0,30 mm +0,1 / -0,2

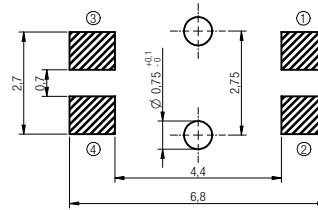

P.C.B. MOUNTING PLAN

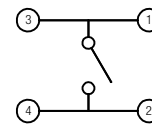

SCHEMATIC

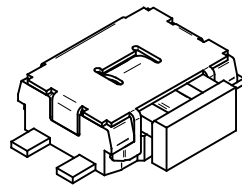
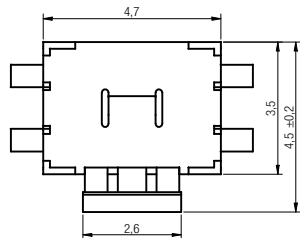
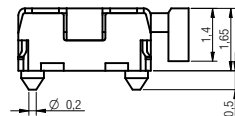
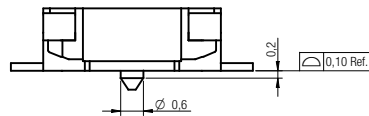
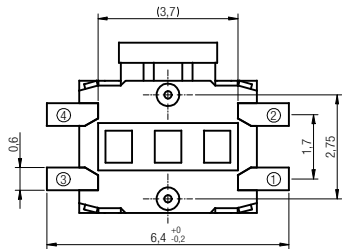

Scale - 5:1

		Projection	GENERAL TOLERANCE .x = +/- 0,2 .xx = +/- 0,15		Basic material	
			Date	Name	DESCRIPTION SwTUS WS-TUS 3,5x4,7 mm side push tact switch with boss design, SMD version	
			Drawn	10-03-22	Jelisarow	
			Checked			
			Würth Elektronik eiCan		Scale	5:1
					Position	
					Drawing.- No.	4363x10458xx
REV	FILE	DATE	BY	EDV NO	4363x10458xx.dft	SIZE A4
						System Solid Edge V20