

Expanded Cable & Connector EMI Suppressor Kit

(Part Number 0199000005)

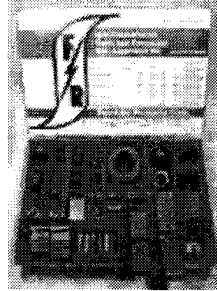

Part Number	Typical Impedance(Ω)			A	B	C	D	E	F	Fig
	10MHz	25MHz	100MHz							
2643102002		146	235	25.9 ± 0.75 1.020	12.8 ± 0.25 500	26.6 ± 0.4 1.125				A
2643025102		130	213	16.86 ± 0.75 625	7.8 ± 0.25 312	28.8 ± 0.75 1.125				A
26431540002	119	181	300	14.3 ± 0.45 500	6.35 ± 0.25 250	28.8 ± 0.75 1.125				A
2643625002		70	113	18.25 ± 0.75 625	7.8 ± 0.25 312	14.3 ± 0.35 562				A
2643665802		55	88	17.45 ± 0.4 687	8.8 ± 0.25 375	12.7 ± 0.5 500				A
2643803902		58	108	51.8 ± 1.3 2.400	35.55 ± 0.75 1.400	12.7 ± 0.5 500				A
2631102002	103	155	260	25.9 ± 0.75 1.020	12.8 ± 0.25 500	28.5 ± 0.5 1.125				A
2643804502		80	100	31.1 ± 0.75 1.225	19.05 ± 0.5 750	16.3 ± 0.75 627				A
2643540002		171	250	14.3 ± 0.45 582	8.35 ± 0.25 250	28.8 ± 0.75 1.125				A
2643166751		80	93	7.85 ± 0.25 290	2.3 ± 0.25 95	7.8 ± 0.5 297	3.9 ± 0.25 148			B
2643026502		225	348	19.0 ± 0.85 735	10.15 ± 0.25 400	40.5 ± 1.0 2.000				A
2643065702		125	200	17.85 ± 0.4 687	9.5 ± 0.25 375	28.6 ± 0.75 1.125				A
2631665702	89	138	225	17.45 ± 0.4 687	9.5 ± 0.25 375	28.6 ± 0.75 1.125				A
2643801002		28	47	29.8 ± 0.75 1.142	19.8 ± 0.5 748	7.5 ± 0.25 250				A
2643802702		48	80	35.55 ± 0.75 1.400	22.85 ± 0.5 900	12.7 ± 0.5 500				A
2644245701		13	28	7.44 ± 0.10 293	4.90 ± 0.10 193	1.52 ± 0.12 600	2.54 ± 0.13 100	2.54 ± 0.10 100	1.22 ± 0.07 048	D
2644246201		14	28	6.86 ± 0.10 291	3.88 ± 0.10 152	1.82 ± 0.13 200	2.08 ± 0.08 079	2.08 ± 0.08 079	0.82 ± 0.1 034	D
2644246001		14	28	3.88 ± 0.10 152	3.88 ± 0.10 152	1.82 ± 0.13 200	2.08 ± 0.08 079	2.08 ± 0.08 079	0.82 ± 0.1 034	C
2644245901		13	28	4.90 ± 0.10 193	4.90 ± 0.10 193	1.82 ± 0.13 200	2.54 ± 0.13 100	2.54 ± 0.10 100	1.22 ± 0.07 048	C
2644247301		13	28	8.22 ± 0.16 245	3.30 ± 0.10 133	1.82 ± 0.13 200	1.27 ± 0.10 250	1.27 ± 0.08 650	0.68 ± 0.05 227	E
2643166851		100	210	38.1 ± 1.0 1.500	26.65 ± 0.75 1.050	25.4 ± 0.75 1.000	6.88 ± 0.25 250	6.85 ± 0.2 033		F
2643163851		95	195	38.1 ± 1.0 1.500	26.65 ± 0.75 1.050	25.4 ± 0.75 1.000	12.05 ± 0.4 475	1.8 ± 0.4 075		G
2631163851	83	106	205	38.1 ± 1.0 1.500	26.65 ± 0.75 1.050	25.4 ± 0.75 1.000	12.05 ± 0.4 475	1.8 ± 0.4 075		G
0199001401	-	-	-	15.1 635	11.0 433	12.7 500	11.4 458	8.0 315		H
2643164251		163	275	16.0 ± 0.25 600	8.0 ± 0.3 280	26.6 ± 0.8 1.125	7.8 ± 0.15 288			B
2643167251		130	225	18.85 ± 0.4 796	10.15 ± 0.3 400	28.5 ± 0.8 1.125	9.4 ± 0.15 378			B
2643164151		156	280	26.6 ± 0.5 1.020	13.85 ± 0.3 544	28.8 ± 0.8 1.125	12.85 ± 0.25 510			B
2643166651		98	225	46.1 ± 0.75 1.775	34.4 ± 0.7 1.355	28.6 ± 0.7 1.125	6.35 ± 0.25 250	0.85 ± 0.2 033		F
2643163951		88	225	48.9 ± 1.3 2.500	32.3 ± 1.1 2.050	28.8 ± 0.7 1.125	6.35 ± 0.25 250	0.85 ± 0.2 033		F
2643164051		75	215	76.2 ± 1.5 3.000	65.3 ± 1.3 2.570	28.6 ± 0.8 1.125	6.35 ± 0.25 250	0.85 ± 0.2 033		F

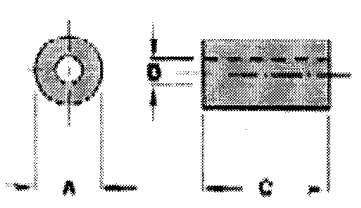

Figure A Round Cable Suppression Core

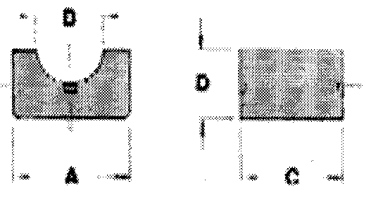

Figure B Split Round Cable Suppression Core

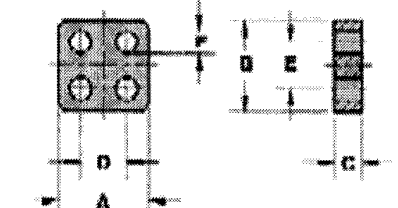

Figure C Miscellaneous Suppression Core

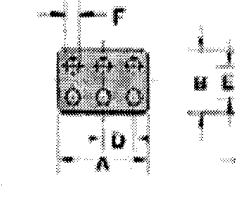

Figure D DIP/Con Plate

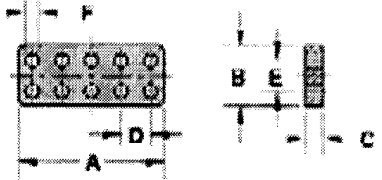

Figure E Connector Plate

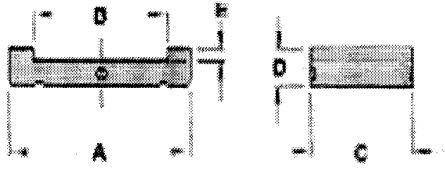

Figure F Split Flat Cable Suppression Core

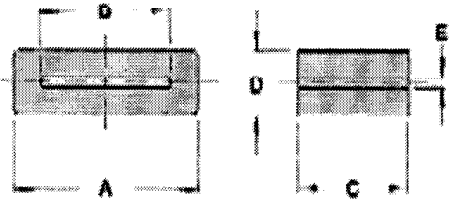
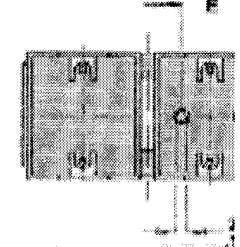

Figure G Flat Cable Suppression Core

Figure H Clio

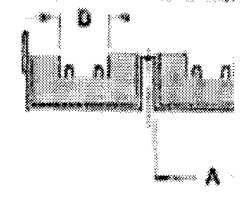

Figure J Case

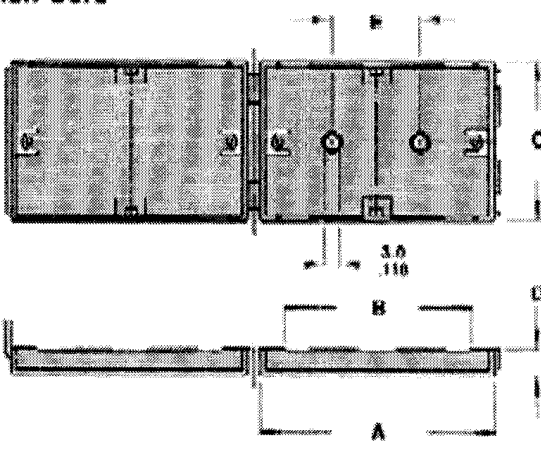

Figure K Case