

TDE Series Low Cost Straight Pcb DSub

A new pcb mount DSub range offering an economic solution while retaining a high level of performance and standard features.



- Low Cost
- Straight Pcb Mounting
- 0.38um (15u") Gold Plated Contacts
- Boardlocks Included as Standard
- Choice of 4-40 Threaded Inserts or Female Screwlocks
- UL Approved

Specification

Front shell	Steel, tin plated
Housing	Black thermoplastic
Flammability	UL 94V-0
Contact material - pin	Brass
Contact material - socket	Phosphor bronze
Contact area plating	0.38um Au
Current rating	3A
Insulation resistance	1000 MΩ min
Dielectric strength	500Vdc for 2 mins
Temperature rating	-55 to +105C
UL file no	E28476

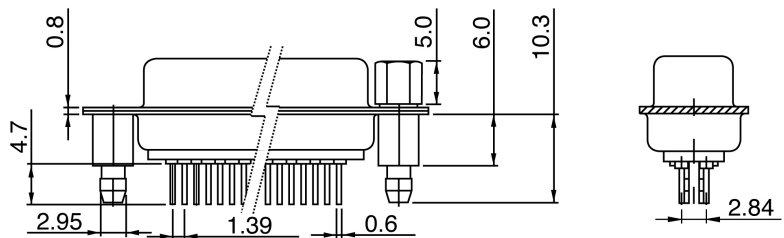

All dimensions in mm

Plug with Boardlocks

No of Ways	4-40 Threaded Inserts	4-40 Female Screwlocks
9	1-1634218-2	3-1634218-2
15	1-1634219-2	3-1634219-2
25	1-1634220-2	3-1634220-2
37	1-1634221-2	3-1634221-2

Socket with Boardlocks

No of Ways	4-40 Threaded Inserts	4-40 Female Screwlocks
9	1-1634222-2	3-1634222-2
15	1-1634223-2	3-1634223-2
25	1-1634224-2	3-1634224-2
37	1-1634225-2	3-1634225-2

Connectors with M3 threaded inserts or screwlocks are available on request