

0138 copper washer

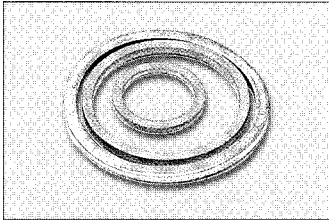

C		G1	G2	K
10	0138 10 00	10,3	13,5	1
13	0138 13 00	13,5	18	1,5
17	0138 17 00	17,3	21	1,5
21	0138 21 00	21,3	26	1,5
27	0138 27 00	27,3	32	2
33	0138 33 00	33,5	39	2

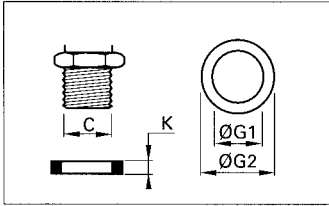

0602 captive sealing washer

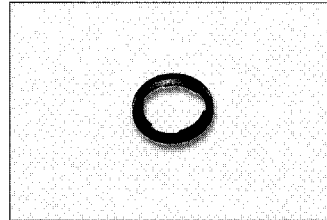

C		G1	G2	K
M5	0602 29 93 15	5,2	7,8	1,5
1/8	0602 23 10 20	10,3	14	2
1/4	0602 23 11 20	13,7	17,5	2
3/8	0602 23 12 20	17,2	21	2
1/2	0602 23 13 20	21,5	25,5	2,5
3/4	0602 27 32 20	27	32	2,5
1"	0602 30 60 20	33,8	39	3

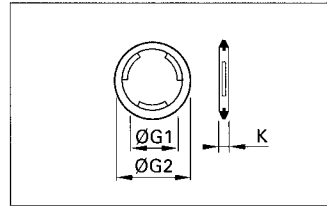

plastic

0920 female bulkhead connector BSPP and M5

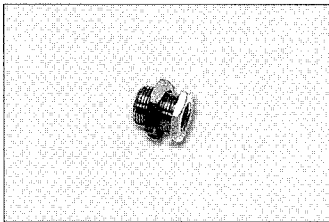

C	C1		F	F1	K	L1	L2	T
			maxi					mini
M5	M10x1	0920 00 19	14	14	7	10,5	3,5	10,5
1/8	M16x1,5	0920 00 10	19	22	9	14	4	16,5
1/4	M20x1,5	0920 00 13	24	27	15	21	4	20,5
3/8	M26x1,5	0920 00 17	30	32	14	21	5	26,5
1/2	M28x1,5	0920 00 21	32	36	20	27	6	28,5

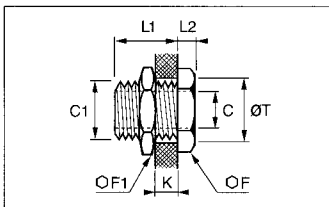

3312 female cross manifold BSPP

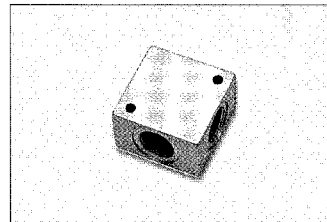

C		H	L	L1	L2	L3	T
M5	3312 00 19	20	20	10	12	12	4,5
1/8	3312 00 10	30	30	16	23	22	4,5
1/4	3312 00 13	40	40	20	30	27	5,5
3/8	3312 00 17	50	50	25	38	39	6,5
1/2	3312 00 21	60	60	30	42	42	6,5

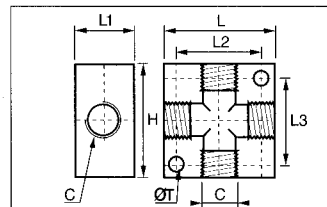

3311 female manifold BSPP

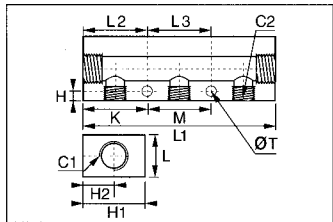
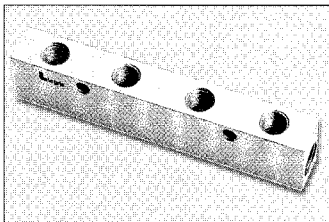

C1	C2		Number of outlets	H	H1	H2	K	L	L1	L2	L3	M	T
1/8	M5	3311 19 10 07	7	4	20	10	10,5	95	15	21,5	52,5	16	5
1/4	1/8	3311 10 13 02	2	4,5	30	15	15,5	61	20	5,5	50	30	5
1/4	1/8	3311 10 13 03	3	4,5	30	15	15,5	91	20	30,5	30	30	5
1/4	1/8	3311 10 13 04	4	4,5	30	15	15,5	121	20	30,5	60	30	5
1/4	1/8	3311 10 13 05	5	4,5	30	15	15,5	151	20	30,5	90	30	5
1/4	1/8	3311 10 13 06	6	4,5	30	15	15,5	181	20	30,5	120	30	5
3/8	1/4	3311 13 17 02	2	6	30	11	19	74	20	6,5	61	36	6,5
3/8	1/4	3311 13 17 03	3	6	30	11	19	110	20	37	36	36	6,5
3/8	1/4	3311 13 17 04	4	6	30	11	19	146	20	37	72	36	6,5
3/8	1/4	3311 13 17 05	5	6	30	11	19	182	20	37	108	36	6,5
3/8	1/4	3311 13 17 06	6	6	30	11	19	218	20	37	144	36	6,5

3313 double female manifold BSPP

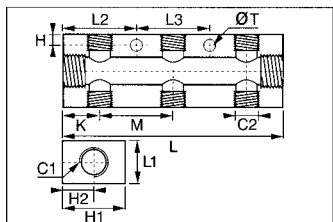
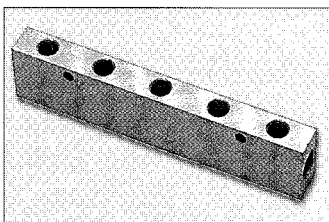

C1	C2		Number of outlets	H	H1	H2	K	L	L1	L2	L3	M	T
1/4	1/8	3313 10 13 02	2 x 2	4,5	30	15	15,5	61	20	5,5	50	30	5
1/4	1/8	3313 10 13 03	2 x 3	4,5	30	15	15,5	91	20	30,5	30	30	5
1/4	1/8	3313 10 13 04	2 x 4	4,5	30	15	15,5	121	20	30,5	60	30	5
1/4	1/8	3313 10 13 05	2 x 5	4,5	30	15	15,5	151	20	30,5	90	30	5
3/8	1/4	3313 13 17 02	2 x 2	6	40	20	19	74	20	6,5	61	36	6,5
3/8	1/4	3313 13 17 03	2 x 3	6	40	20	19	110	20	37	36	36	6,5
3/8	1/4	3313 13 17 04	2 x 4	6	40	20	19	146	20	37	72	36	6,5
3/8	1/4	3313 13 17 05	2 x 5	6	40	20	19	182	20	37	108	36	6,5
1/2	1/4	3313 13 21 03	2 x 3	6	40	20	22	116	28	40	36	36	6,5
1/2	1/4	3313 13 21 04	2 x 4	6	40	20	22	152	28	40	72	36	6,5
1/2	1/4	3313 13 21 05	2 x 5	6	40	20	22	188	28	40	108	36	6,5

manifolds 3311, 3312 and 3313

Technical specification

- working pressure : 20 bar maximum
- thread characteristics :
 - parallel : ISO 228.1 - NFE 03.005
 - metric : ISO 68.1 - NFE 03.001

- working temperature : -10 ° to + 80 ° C
- constituent materials : anodised 11S aluminium