

TR5® / No. 373/378 UL 248-14, 250V, F

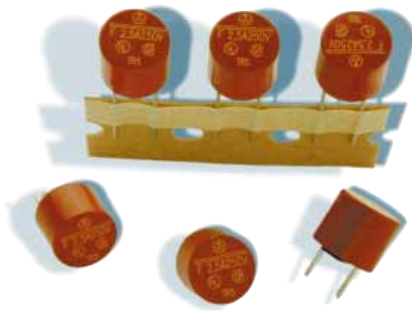

Dimensions (mm)

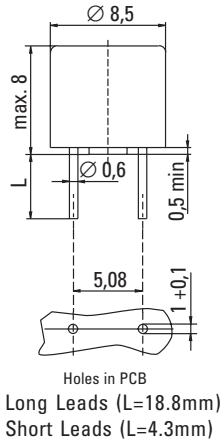

Limits for Pre-arcing Time

Rated Current	$2.0 \times I_{Rated}$	$2.0 \times I_{Rated}$
50mA ... 6.30A ¹	< 60s	< 5s

Time-Current Characteristic

Quick Acting (F)

Standard

UL 248-14
CSA C22.2 No. 248.14

Approvals

UL Listed: File No. E 67006
CSA Certified: File No. 51378

Features

Reduced PCB space requirements
Direct solderable or plug-in versions
Internationally approved
Low internal resistance
Shocksafe casing
Vibration resistant

WebLinks

Data Sheet

www.wickmann.com/products/373.pdf

Approval Certificates

www.wickmann.com/approvals

Time-Current Curve

Page 58
www.wickmann.com/itcurves

Packaging

Page 118
www.wickmann.com/pack

FaxBack Document # 301



Specifications

Packaging

000: Tape/Ampopack (1000 pcs.)
041: Short Leads - Bulk (1000 pcs.)

Materials

Base/Cap: Brown Thermoplastic
Polyamide PA 6.6, UL 94V0
Round Pins: Copper alloy, tin plated

Operating Temperature

-40°C to +85°C (consider de-rating)
-25°C to +70°C (8A, 10A; consider de-rating)

Climatic Category

-25°C/+70°C/21 days (EN 60068-1..3)

Stock Conditions

+10°C to +60°C
relative humidity ≤ 75% yearly average,
without dew, maximum value for 30 days-95%

Vibration Resistance

24 cycles at 15 min. each (EN 60068-6)
10 - 60Hz at 0.75mm amplitude
60 - 2000Hz at 10g acceleration

Lead Pull Strength

10N (EN 60068-2-21)

Solderability

260°C, ≤ 3 sec. (Wave)
350°C, ≤ 1 sec. (Hand)

Soldering Heat Resistance

260°C, 10 sec. (IEC 60068-2-20)

Marking

 TR5, 250V, T, Current Rating, Approvals

Unit Weight

0.77g (approx.)

Permissible continuous operating current is ≤ 70% at ambient temperature of 23°C (73.4°F).

Rated Current	Amp Code	Voltage Rating	Breaking Capacity	Voltage Drop $1.0 \times I_{Rated}$ max. (mV)	Power Dissipation $1.0 \times I_{Rated}$ max. (mW)	Melting Integral $10 \times I_{Rated}$ max. (A ² s)	Approvals UL CSA
No. 373							
50mA	0050	250V		1400	70	0.0001	• •
63mA	0063	250V		1300	85	0.00023	• •
80mA	0080	250V		1200	100	0.00037	• •
100mA	0100	250V		1100	110	0.0013	• •
125mA	0125	250V		1000	125	0.0019	• •
160mA	0160	250V		950	155	0.004	• •
200mA	0200	250V		850	170	0.0065	• •
250mA	0250	250V		750	190	0.014	• •
315mA	0315	250V		650	205	0.032	• •
400mA	0400	250V	50A / 250VAC	230	95	0.016	• •
500mA	0500	250V	50-60Hz	220	110	0.024	• •
630mA	0630	250V	cos φ = 1.0	210	135	0.039	• •
800mA	0800	250V		200	160	0.069	• •
1.00A	1100	250V		190	190	0.11	• •
1.25A	1125	250V		180	225	0.2	• •
1.60A	1160	250V		170	275	0.38	• •
2.00A	1200	250V		160	320	0.63	• •
2.50A	1250	250V		150	375	1.2	• •
3.15A	1315	250V		140	445	1.9	• •
4.00A	1400	250V		130	520	3.5	• •
5.00A	1500	250V		120	630	6.2	• •
6.30A	1630	250V		115	1000	9.1	• •
No. 378 for short circuit back-up protection							
8.00A ²	1800	250V	50A / 250VAC	120	1800	26	
10.00A ²	2100	250V	50-60Hz/cos φ = 1.0	110	2500	49	

¹ Ratings 8.00A and 10.00A: $0.7 \times I_{Rated} > 4h$; $2.0 \times I_{Rated} < 60s$ ² Conducting path cross-section minimum $\geq 0.2mm^2$

Order Information

Qty.	Order-Number	Series	Amp Code	Packaging

TR5[®] / No. 373

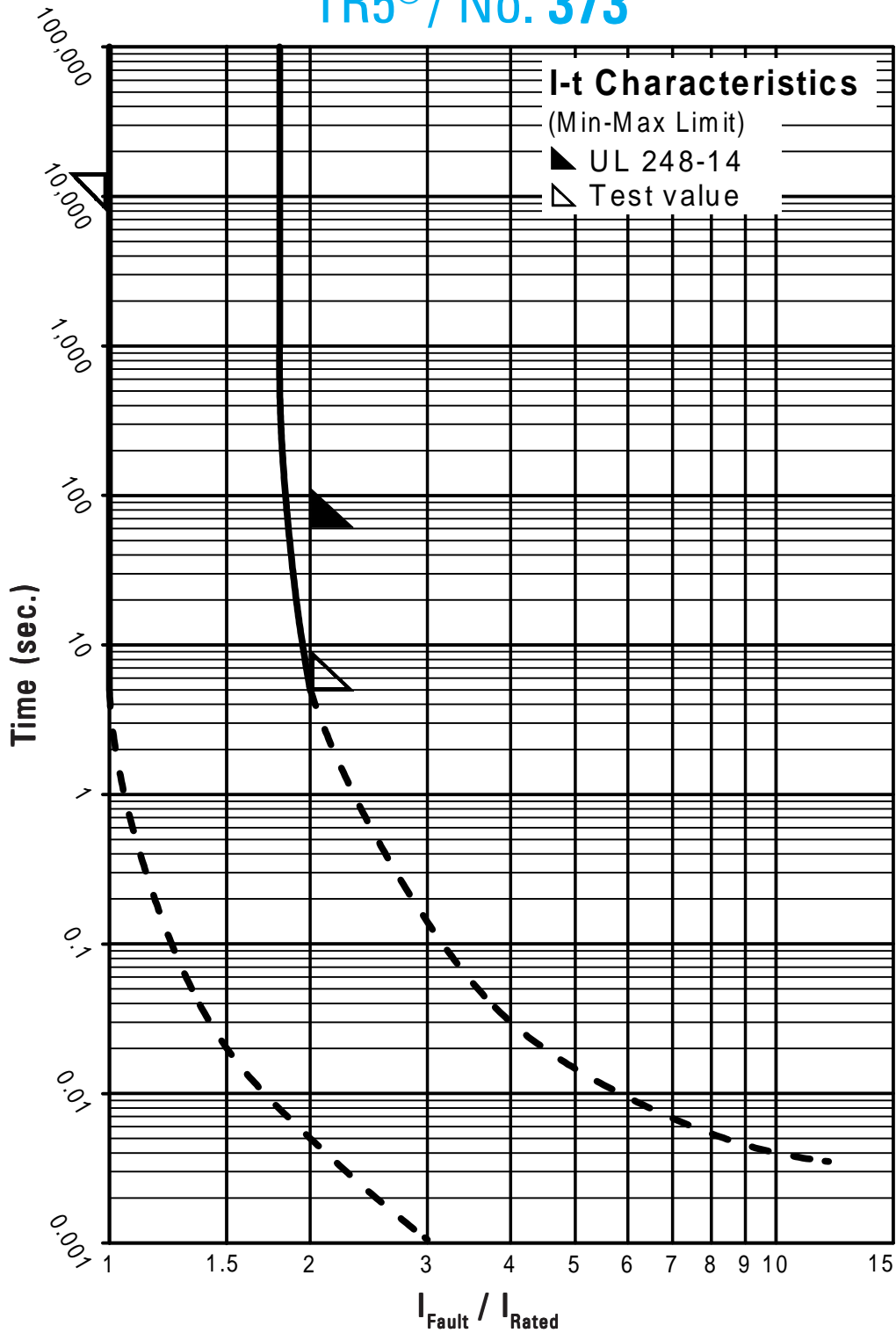

Contact WICKMANN for individual I-t curves